

- Remote Color TV's
- Microwave Oven in Kitchen units
- Irons and Ironing Boards
- Indoor Hot Tub
- Refrigerators All Rooms
- Private Balconies Most Rooms
- Kitchens, Utensils, Dishes, Silverware
- Coin Launderette
- All Upper Rooms are Non-Smoking
- Putting Green (Free)
- Heated Pool (In Season)
- 300 Feet To Ocean Across the Street
- Automatic Dial Room Phones
- Outside Grilling Area
- Daily Maid Service
- Wall To Wall Carpet
- Ample Parking On Premises
- Public Tennis Courts Nearby
- Wireless Internet Available in Lobby area

S E E U R E F U T A E

RESERVATION REQUEST
 NO ONE IS AUTHORIZED TO
 CHANGE ANY PART OF
 THIS RATE SCHEDULE.

Waikiki Village

1500 S. Ocean Blvd. • Myrtle Beach, SC 29577
 Phone 843-448-8431

“A FAMILY MOTEL”
RESERVATION REQUEST
 nancywaikiki@aol.com

Print Name _____ **Phone No.** _____

Street Address _____ **City** _____ **State** _____ **Zip** _____

Please Reserve Type Room _____ **New Guest** _____ **Repeat Guest** _____

Email _____ **Adults** _____ **Children Under 12** _____ **Children Over 12** _____

Date Arriving _____ **Arrival Time** _____ **Date Departing** _____

A deposit of one night's rental is required within 10 days for all reservations. **Foreign checks must be made in US funds and under \$200.00 to avoid additional bank fees. Deposit will be applied to last night of reservation. Balance due at check-in.** Refund of deposit less \$10.00 service charge if notification is received 21 days before arrival date during September - May and 14 days during June - August. This is because we are a destination resort and do not commonly have "walk-ins" to replace you. No refund after check-in. Cash, Visa, MasterCard, and Travel Checks **ONLY** at check-in. **NO PERSONAL CHECKS ACCEPTED UPON ARRIVAL.** Sorry, we can not honor requests for specific rooms... **ONLY TYPES OF ROOMS: NO PETS, PLEASE.** A key deposit is required on all additional rooms keys. Please note arrival date and departure date carefully. Guests are expected to stay for the entire period for which room is reserved.

Office is not open 24 hours and our office hours are seasonal.
Please inform us of your arrival time.
CHECK-IN TIME: BEGINS at 2:00 P.M.
CHECK-OUT TIME: 11:00 A.M. OR EARLIER

**Reservations must check-in before 11:00 p.m. from
 Mar. 1 - Oct. 30 and before 9 p.m. from Nov. 1 - Feb. 28**

Waikiki Village

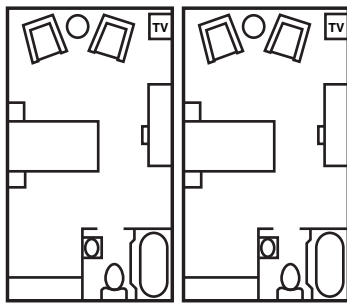

TYPE A **TYPE B**
A, B, & BB rooms - no pool view.

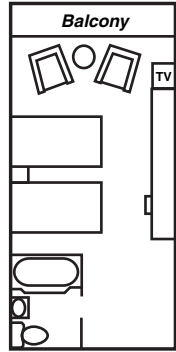

TYPE C

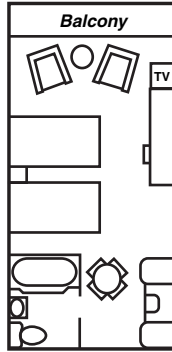

TYPE D

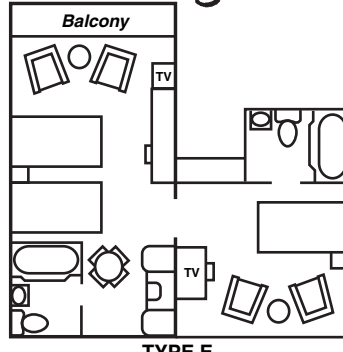

TYPE E

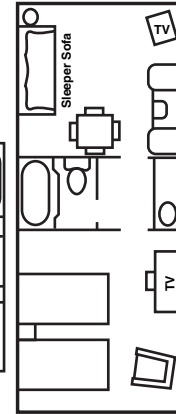

TYPE F and G

**CATERING
TO
FAMILIES
AND
MATURE
COUPLES**

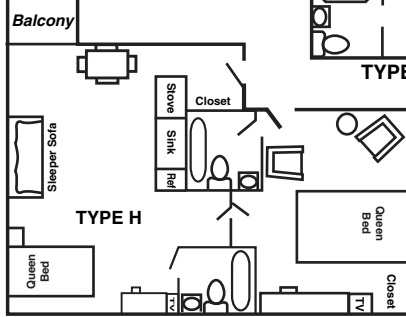

TYPE H

D, E, and H - Pool Area Type F - Streetside Type G - Pool Area



SUPER SAVER DAYS
Pay For 4 Nights And Get The 5th For FREE!

April 1-5 May 20-25
April 15-19 May 28 - June 7
May 6 - 10 Aug. 19 - 30

Sept. 23-28

NO ONE IS AUTHORIZED TO CHANGE ANY PART OF THIS RATE SCHEDULE.

Toll Free 1-866-344-8431

(Limited Hours) FOR RESERVATIONS ONLY

2012 Rate Schedule	Oct. 21 - Feb. 9	Feb. 10 - Mar. 31 Sept. 16 - Oct. 20	Apr. 1 May 25	May 26 - June 30	July 1 - July 28	July 29 - Aug. 11	Aug. 12 - Sept 2	Sept. 3 - Sept 15
	Day Week	Day Week	Day Week	Day Week	Day Week	Day Week	Day Week	Day Week
A 1 Queen Bed Small Eff. Apt. in Small Hawaiian Style Building. 2 Persons Only.	30 188	35 220	45 283	70 441	74 466	65 409	52 327	40 252
BB 1 Full Bed Small Room in Small Hawaiian Style Building. 2 Persons Only.	25 155	26 164	32 200	54 340	58 366	45 283	36 226	32 202
B 1 Bedroom in Main Building. (Queen Bed) No View. 2 Persons Only.	27 170	30 189	42 264	67 422	72 453	60 375	47 296	36 226
C 2 Queen Beds. Private Balcony. 2 Adults, 2 Children Under 12.	32 200	38 239	57 359	80 504	91 573	80 504	66 416	47 296
D 1 Bed or 2 Q. Bed Eff. Apt., Private Balcony 2 Adults, 2 Children Under 12.	34 214	40 252	59 371	83 522	93 585	83 522	68 428	50 315
E 3 Queen Beds, Eff. 2 Rms., 2 Baths, 2 TVs 4 Adults, 2 Children Under 12.	58 365	67 422	92 579	124 781	156 982	123 774	100 630	82 516
F 2 Room Eff. Apt., 1 Bath, 2 TVs, 2 Full Beds, 1 Hide-a-Bed. 2 Adults, 2 Children Under 12.	38 239	44 277	60 378	86 542	96 605	85 535	70 441	52 327
G 2 Room Eff. Apt., 1 Bath, 2 TVs, 2 Full Beds, 1 Hide-a-Bed. 2 Adults, 2 Children Under 12.	40 252	48 302	62 390	88 554	98 617	87 548	72 454	54 340
H 2 Room Eff. Apt., 2 Baths, 2 TVs, 2 Q. Beds, 1 Twin Sleeper Sofa-5 Persons Max. (Room 218 & 220)	54 340	64 403	86 541	116 730	150 945	112 705	92 580	77 485

Rates higher on holidays, weekends, special events and one night stays.

No refunds for any early departures.

Office is not open 24 hours and our office hours are seasonal. Please inform us of your arrival time.

Additional person \$5.00 day including children.

All Rates Subject to State and Local Tax.

C, D, F, and G rates for 1 family only.

Only 1 extra person in C, D, E, F & G

Extra persons/children not allowed in A, B, BB or H unit.

CHECK-IN TIME begins at 2 P.M. CHECK-OUT TIME is 11 A.M. or before

NO PERSONAL CHECKS AT CHECK-IN TIME.

NO ALCOHOL CONTAINERS ALLOWED OUTSIDE OF ROOM. SORRY! NO PETS ALLOWED.

**MONTHLY RENTALS AVAILABLE
OCTOBER - MARCH**

nancywaikiki@aol.com
www.waikikivillagemb.com

FOREIGN CHECKS MUST BE MADE IN US FUNDS AND UNDER \$200.00 TO AVOID ADDITIONAL BANK FEES.